

Fuselage Manual TERRIER 200



Glue the doorframe top, front and rear # 2-1045/46/47 in.



Cut the doors out, leave the rear corner 120mm x 60mm.

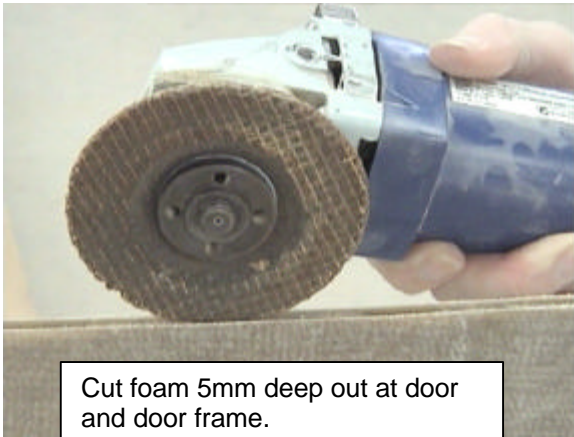

Cut foam 5mm deep out at door and door frame.

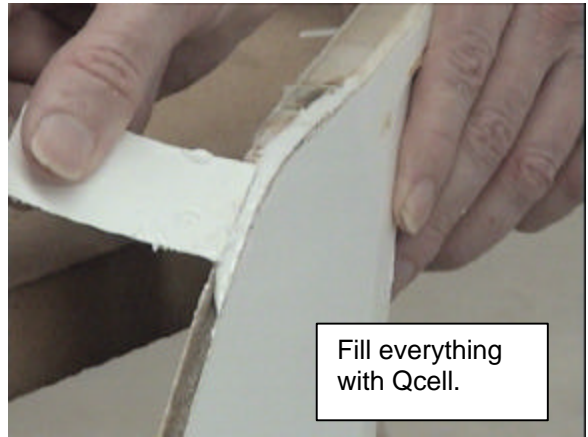

Fill everything with Qcell.

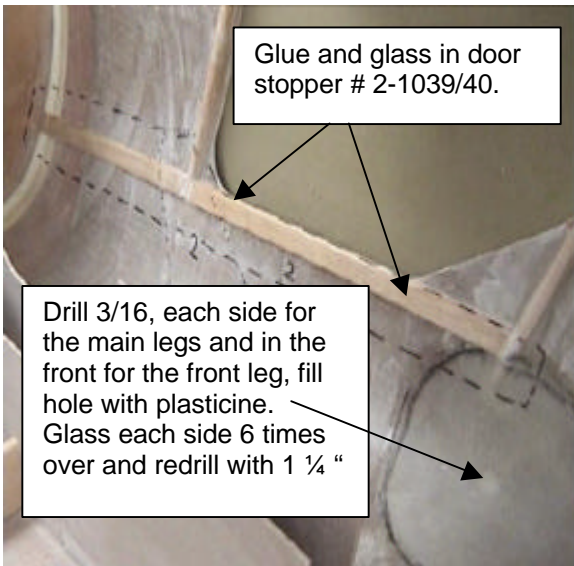

Glue and glass in door stopper # 2-1039/40.

Drill 3/16, each side for the main legs and in the front for the front leg, fill hole with plasticine. Glass each side 6 times over and redrill with 1 1/4 "

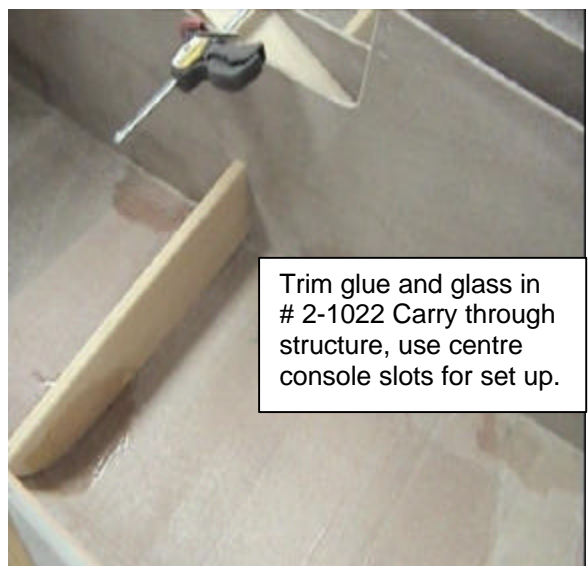

Trim glue and glass in # 2-1022 Carry through structure, use centre console slots for set up.

© Copyright Foxcon Aviation Mackay

Fuselage Manual TERRIER 200	No:021001
	Rev: 12/02
Foxcon Aviation Mackay, QLD.	Page: 2 of